



SmartAC1

Hybrid Biometric Access Control and Time attendance with Enhanced Visible Light Facial Recognition Terminal



Proactive Facial Recognition



New Height of Anti-Spoofing



Speedy Recognition



Wide Pose Angle Acceptance



Touchless for Better Hygiene

Features

- Enhanced Visible Light Facial Recognition
- Anti-spoofing algorithm against print attack(laser, color and B/W photos), videos attack and 3D mask attack.
- Multiple Verification: Face/FingerPrint/ Card/Password
- Supplement light with adjustable brightness
- Recognition distance: 0.3-2m

Recognition distance up to 2m long and extra wide angle recognition

The recognition distance has been greatly extended up to 2 meters long, which significantly improves maximum traffic rate. While most of algorithms only support 15-degree angle facial recognition, ZKTeco supports 30-degree angle facial recognition.

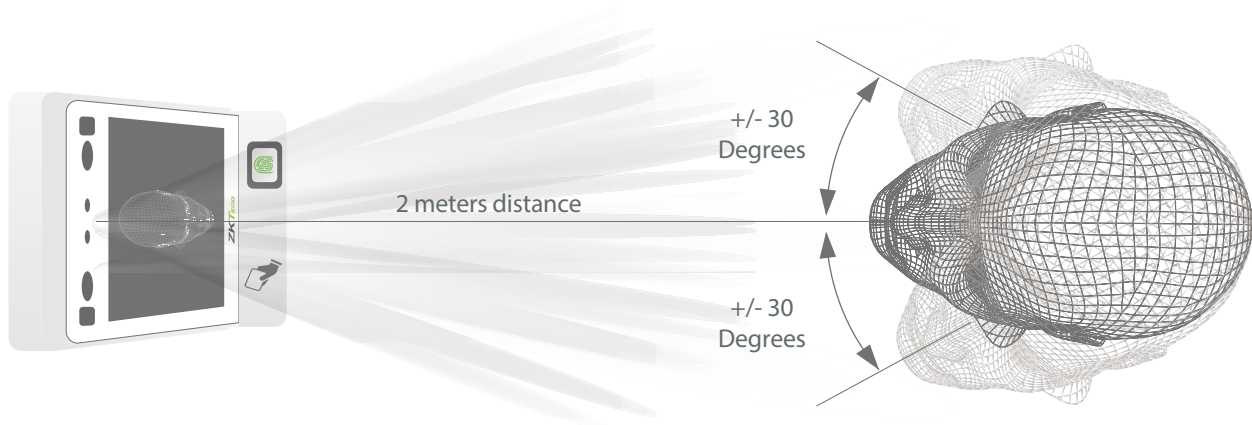
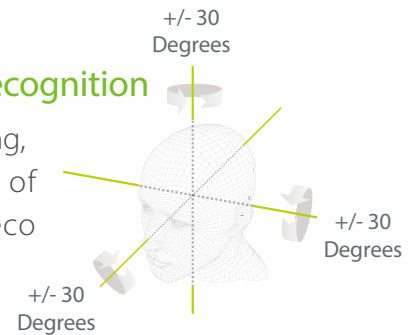

Specifications

Display	5-inch Touch Screen
Face Capacity	3,000
FingerPrint Capacity	3,000
Card Capacity	10,000 (Optional)
Transactions	100,000
Communication	TCP / IP, WIFI, Wiegand input / output, RS485, RS232
Standard Functions	ADMS, T9 Input, DST, Schedule Bell, Camera, 9 digit user ID, Access Levels, Groups, Holidays, Anti-passback, Record Query, Tamper Switch Alarm, Multiple Verify Mode
Hardware	900MHZ Dual Core CPU Memory 512MB RAM / 8G ROM 2MP WDR Low Light Camera Adjustable Light Brightness LED
Operation System	Linux
Access Control Interface	3rd Party Electric Lock, Door Sensor, Exit Button, Alarm output, Auxiliary Input
Optional Functions	13.56MHz IC Card
Algorithms	ZKFace V5.8& ZKFinger V10.0
Face Recongntion Speed	≤1s
Power Supply	12V 3A
Operating Humidity	10%-90%
Operating Temperature	-10 °C- 45 °C
Dimensios	91.93*202.93*21.5mm
Compatibility	ZKBioAccess / ZKBioSecurity

Configuration

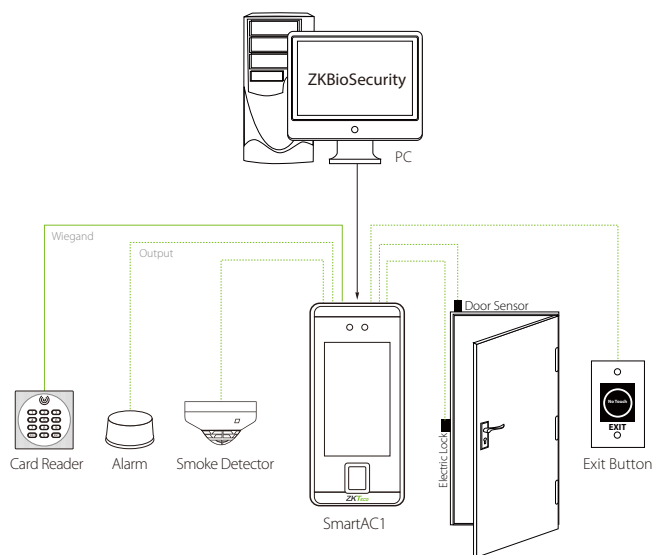

Optional Accessories

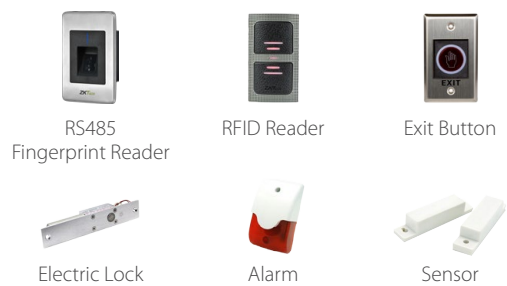

Dimensions(mm)

